

Cruise only 遊輪船票

Jetour 捷旅
The Art of Travel

7 晚 – 阿拉斯加恩迪科特峽灣之旅

7 Nights – Alaska Dawes Glacier

名人愛極號 Celebrity Edge

CZZALSCL_24068_JT

2nd Revised 11 Jun 24

AC 10

Celebrity X Cruises®

朱諾, 阿拉斯加 Juneau, Alaska



■ Celebrity Edge 名人愛極號

總噸位 Gross Tonnage	130,818 tons
首航年份 Inaugural	2018 年
載客 Passenger	2,918 人
船員 Crew	1,320 人
甲板 Decks	16 層

全新旗艦 EDGE 系列，首創以 3D 技術設計的郵輪，讓客人感受前所未有的娛樂體驗

全新可升降的娛樂休閒設施 Magic Carpet，懸於海上的浮動平台，於不同甲板皆能給予您最新穎的娛樂體驗！

啟航日期: 2024 年 9 月 13 日

HK\$ 5,198 起

日程	停泊港口	預計到達	預計離開
13/9	西雅圖, 美國 – 登船 Seattle, USA – Embarkation	--	1600
14/9	海上航行 At Sea	--	--
15/9	凱奇坎, 阿拉斯加 Ketchikan, Alaska	0700	1600
16/9	朱諾, 阿拉斯加 Juneau, Alaska	0900	2030
17/9	史凱威, 阿拉斯加 Skagway, Alaska	0700	1800
18/9	恩迪科特峽灣, 阿拉斯加 (風景區巡航) Endicott Arm, Alaska (Scenic Cruising)	--	--
19/9	海上航行 At Sea	--	--
20/9	維多利亞, 加拿大 – 離船 Victoria, Canada – Disembarkation	0600	--



價目 Price

成人佔半房 Sharing twin basis

隨機內艙房

Inside (Guarantee) – Cat. Z

無際海景露台房 (景觀受阻)

Edge Strm w/Infinite Veranda Partial – Cat. E3

隨機禮賓級艙房

Concierge Class (Guarantee) – Cat. XC

9 月 13 日

HK\$ 5,198 起

HK\$ 11,298 起

HK\$ 12,098 起

郵輪雜費約 HK\$ 2,220 | 港口稅約 HK\$ 2,120 | 以上航程及預計到達/離開時間只供參考，如有更改，恕不另行通知。 | 有部分之海景房 Oceanview、尊貴海景露台房 Deluxe Porthole view w/Veranda、無際海景露台房 Edge Strm w/Infinite Veranda、禮賓級艙房 Concierge Class、水療級艙房 Aqua Class、天空套房 Sky Suite 為景觀受阻，詳情請向本公司職員查詢。

* 隨機艙房不設樓層、艙房號碼選擇，由船公司隨機安排。房間有機會為景觀受阻。

最新資料及價格請參閱 www.jetour.com.hk

f Jetourhk

立即掃描
QR Code 與我們聯絡



7 晚 – 阿拉斯加恩迪科特峽灣之旅

7 Nights – Alaska Dawes Glacier

名人愛極號 Celebrity Edge

CZZALSCL_24068_JT

2nd Revised 11 Jun 24

AC 10



隨著科技的進步，郵輪公司每年都會宣佈其“革命性”的創新技術。名人郵輪 (Celebrity Cruises) 亦將於 2020 年年中推出 EDGE 系列第二艘旗艦 Celebrity APEX，並邀請多位殿堂級設計大師為其構思新概念。當中最令人觸目的莫過於各上首創的 Magic Carpet!

Celebrity EDGE 系列更是首款以 3D 立體科技設計及建造的郵輪。設計人員以 3D 技術設計藍圖，以 VR 技術在立體角度上檢視船上各個細節，更準確計算出各種設施的最佳面積及位置分佈，將各種元素恰到好處地配置到最佳位置。

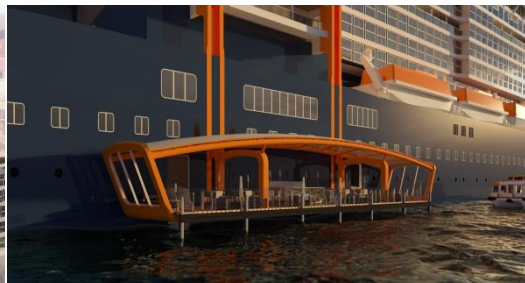

曾負責設計杜拜帆船酒店的英籍名建築設計師 Tom Wright，獲邀為郵輪設計的 Magic Carpet。這是個設於船邊的大型可升降平臺，當 2 樓、5 樓、14 樓及 16 樓停泊，變身戶外甲板、泳池區的延伸、接駁艇等候區域，或變成無邊際海景餐廳等不同功能，成為海上魔氈。



Edge Staterooms with Infinite VerandasSM



Iconic Suites



Edge Villas

Edge 系列另一個獨特創新則是其艙房設計！無際海景露台房的設計融合了艙房的室內和露台的室外空間。設計可以使露台隨時成為室內空間的一部分，從而增加了約 23% 的艙房面積。而全船只得 2 間的 Iconic Suite 面積都將超過 2,500 平方英尺！艙房座落在艦橋之下，將會有與船長一樣的視角，露台更設有私人按摩池供您全程享受。Edge Villa 更樓高 2 層，以室內樓梯連接，配有一房或兩房的選擇，雙浴室的設計亦比以往艙房更適合 4 人居住。乘客亦能享用直達通道前往套房專屬悠閒區「The Retreat」。



7 晚 – 阿拉斯加恩迪科特峽灣之旅

7 Nights – Alaska Dawes Glacier

名人愛極號 Celebrity Edge

CZZALSCL_24068_JT

2nd Revised 11 Jun 24

AC 10



費用包括

- 7 晚遊輪住宿並享用船上美食及娛樂設施
- 旅遊業監管局 0.15%印花稅

費用不包括:

- 郵輪雜費、港口稅、季節性附加費、旅行社服務費
- 需付費岸上觀光、需付費食品及飲品、遊輪燃油附加費(如適用)、船上指定保險費(如適用)
- 護照簽發 / 簽證費用、旅遊保險、其他個人消費
- 其他不列於此列之需收費項目

備註

1. 費用以成人二人一房每位計算，並以港幣計算。單人房、三/四人同房或兒童之費用，請與本公司聯絡。
2. 費用按 **2024 年 6 月 11 日** 之價格作參考指引，價格視乎供應情況並繳付訂金時為準。
3. 以上優惠資料僅供參考之用，船公司將保留權利隨時調整及取消有關之優惠詳情，如有任何調整，恕不另行通知。
4. 如航空公司或遊輪公司增收燃油附加費、其他應繳稅費，乘客須繳付差額，實際金額以船公司公告發出日期為準。有關金額將於確認後釐定並加到最終的票價。
5. 訂位時需繳付不退還之訂金。餘款必須於訂位確認後 3 個工作日內全數繳付。繳交費用後，恕不可作任何改動。任何姓名或出發日子之改動，將會視作取消行程處理。套票必須於出發前最少 5 個工作日預訂。
6. 訂位時的乘客姓名全寫必須與旅遊證件上的全名相同，任何修改將會導致失去原來之訂位、失去原來之優惠價及導致修改費用。
7. 套票在任何情況下都不能更改、轉讓或退還款項。
8. 機票及船票可於出發前 3 日內領取。
9. 出發後因迫不得已之理由(如戰爭、政治動盪、天災、疫症、惡劣天氣、交通工具發生技術問題、載運機構臨時更改班次或時間表、罷工和工業行動等)更改項目而增加經營成本，本公司可向顧客徵收額外費用。
10. 如因天氣惡劣、海面狀況或各種未能預知或迫不得已的情況下(如戰爭、政治動盪、天災、疫症、惡劣天氣、交通工具發生技術問題、載運機構臨時更改班次或時間表、罷工和工業行動等)而不能停靠或更改行程，顧客同意及接受船公司或「本公司」不需作出任何補償。
11. 航程中港口啟航/抵達/停泊時間會按航行情況有所調整/更改/取消，以遊輪公司最後安排為準，顧客同意及接受遊輪公司有最終的決定及不會當作違反商品說明條例，亦就此放棄向遊輪公司或「本公司」追討或索償。
12. 乘客需持有回港日期起計不少於 6 個月以上有效護照及入境簽證，本公司對乘客因個人證件所產生之任何問題概不負責。
13. 「旅遊業監管局」(TIA)建議乘客出發前購買綜合旅遊保險。
14. 以上費用及條款如有任何更改，恕不另行通知，其他條款按本公司「責任及細則」為準，詳情請與本公司職員查詢或瀏覽本公司網頁。
15. 以上優惠及價錢只適用於 2024 年 6 月 11 日或以後報名之新客戶。
16. 船公司將保留以上優惠之最終決定權。

遊輪備註

1. 客人報名時請提供有效旅遊證件之副本。
2. 遊輪上各項收費，均以美元結算，敬請注意。
3. 船上服務人員小費為：每人每晚美元 US\$ 18 水療級/禮賓級：US\$ 18.5；套房級 (Suite)：US\$ 23 於船上繳付。
4. 艙房號碼、層數及位置將於辦理登船手續時由遊輪公司派發，並以遊輪公司之最後安排為準。
5. 遊輪公司亦可在不收取額外費用下提升艙房至較高級別，客人不得異議。
6. 其他有關遊輪公司之條款及細則，均以遊輪公司英文行程書內之條款及網上刊登之條款為準，請瀏覽網頁 www.celebritycruises.com。
7. 本公司及遊輪公司保留權利隨時更改以上條款及細則，若有任何異議，本公司及遊輪公司保留一切最終決定權。
8. 尚有其他艙房及套房級別，詳情請與本公司職員聯絡。

Fares includes:

- 7 nights cruise onboard including accommodation, meals, entertainment & access to facilities.
- TIA 0.15 % Levy.

Fares EXCLUDED:

- NCCF, Government fees, Seasonal Surcharge, Travel Agent Service Fee.
- Priced Shore Excursions, Priced Food & Beverage items, Cruise Fuel Surcharges (if applicable), Cruise Insurance Premium (if applicable)
- Passport / Travel Visa Fees, Travel Insurance, Any Personal Expenses
- Including, but not limited to, any information relating to policy of Cruise Company.

General Terms & Conditions :

1. Fares quoted are per person in Hong Kong Dollars based on double occupancy. Single/Triple/Quad or Child fare is available on request basis.
2. Arrangements of dinner at main dining room will be nominated by Cruise Company. There is no option for choosing first or second dining time.
3. Fares listed on the flyer are based on quotation as of **11 Jun, 24**, it is subject to availability and to be confirmed at the time of a paid reservation.
4. All promotion details are for reference only. Cruise Company reserves the right to change and withdraw the promotion details anytime without prior notice.
5. Travel agent reserves the right to collect fuel supplements, applicable taxes which imposed by the carrier, even full payment has been made to the reservation. Fare difference is governed by official notification from cruise line. These amounts will be determined upon your confirmation of booking and will be added to the final fare.
6. Non-refundable deposit is required upon confirmation to secure a booking. Full payment must be made within 3 days after confirmation. No change is allowed once payment is made, amendment on names or dates will consider as cancellation. Reservation must be made not less than 5 days before departure.
7. Passengers' full name as shown on travel document is required at the time of booking. Amendment will likely result in fare difference, loss of reservation and / or incurring amendment fees.
8. Package is non-endorsable, non-reroutable and non-refundable.
9. Flight and Cruise documents can be received in 3 days before departure.
10. If a material alteration to a package tour after its commencement for reasons beyond control, the travel agency may impose any additional charge to his clients as a result of an increase in operation costs. ("Reasons beyond control" means hostilities, political unrest, natural disasters, pestilences, bad weather, technical problems to transport, changes to the frequency or timetable of any means of conveyance by its operator without advance notice, strikes, industrial action, etc.)
11. Passengers accept full responsibility for all losses and expenses due to "Reasons beyond control". Cruise Company and the travel agency will not be liable for any consequences. ("Reasons beyond control" means hostilities, political unrest, natural disasters, pestilences, bad weather, technical problems to transport, changes to the frequency or timetable of any means of conveyance by its operator without advance notice, strikes, industrial action, etc.)
12. Cruise Company reserves the right to change itinerary, timing of all embarkations/disembarkations, and cancel port of calls due to weather conditions or specific reasons. All of the changes will not be considered as against "The Trade Descriptions Ordinance, Chapter 362, Laws of Hong Kong". Passengers shall not make claim against Cruise Company and the travel agency for any recovery.
13. Passengers' passport validity is required to have at least 6 months prior the return date and valid traveling visa(s) is granted. Travel agency will not be liable for any consequences.
14. Travel Industry Authority recommends passenger to take out the travel insurance before the journey.
15. The above Terms and Conditions are subject to change without prior notice. Travel agency reserves the rights to alter the terms & conditions and make final decision in case of any disputes.
16. The above fares and promotions are only valid to the reservation that made on or after 11 Jun, 24.
17. In case of disputes, Cruise Company reserves the right to make the final decision..

Cruise Terms & Conditions :

1. Passport copies are required for reservation.
2. Shipboard currency: US Dollars.
3. Gratuities of US\$ 18 per person / night (Aqua/Concierge Class at: US\$ 18.5 per person/night ; Suites or above at: US\$ 23 per person/night) will be charged to shipboard account automatically.
4. Stateroom assignment is subject to the cruise company, and on best available basis.
5. Cruise company reserves the right to upgrade a guest or guests to higher category accommodations at no additional cost.
6. Other terms and conditions remain the same as laid on www.celebritycruises.com
7. Fares and availability for single room, triple/quadruple or child share may available on request basis.
8. Fares of other categories available upon request.

查詢及報名熱線

3180 9966

Whatsapp 查詢

9869 5611

香港九龍尖沙咀廣東道28號 力寶太陽廣場10樓1004-1006室



jetourtravelhk

捷旅旅遊有限公司
Jetour Travel Limited

牌照號碼: 353020

MEMBER OF JETOUR HOLDING 捷旅集團成員